

NOTICE!!

These documents have been scanned!

Do not place un-scanned documents beneath this notice!

Do not remove this notice from this file!

GPO Jacket No. 560-102
Print Order 61540
Rise Business Services, LLC
Job=AZ15 6/6/2019



Box Number= AZ15125



Claim Begin-End: AMC426814-AMC426816

1 Initial Receipt



AZ15125-12

AMC356595-AMC427389

United States Department of the Interior
Bureau of Land Management
 LANDS/RECREATION & PLANNING
 ONE N CENTRAL AVE
 PHOENIX, AZ 85004 -2203
 Phone: 602-417-9200

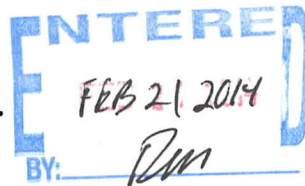

Receipt

No: 2969773

Transaction #: 3058000	
Date of Transaction: 02/18/2014	
CUSTOMER:	
DEPARTMENT OF LAND TRANSFER INFORMATION INC 942 CALLE AMANECER BLDG B548 SAN CLEMENTE, CA 92673-6220 US	

LINE #	QTY	DESCRIPTION	REMARKS	UNIT PRICE	TOTAL
1	3.00	LOCATABLE MINERALS / MINING CLAIMS-NEW, UNADJUD, ONE OR MORE AUTH NOS / NEW MINING CLAIM LOCATION FEE \$34 CASES: AMC426814/\$34.00, AMC426815/\$34.00, AMC426816/\$34.00		- n/a -	102.00
2	3.00	LOCATABLE MINERALS / MINING CLAIMS-NEW, UNADJUD, ONE OR MORE AUTH NOS / NEW MINING CLAIM PROCESSING FEE CASES: AMC426814/\$20.00, AMC426815/\$20.00, AMC426816/\$20.00		- n/a -	60.00
3	3.00	LOCATABLE MINERALS / MINING CLAIMS-NEW, UNADJUD, ONE OR MORE AUTH NOS / NEW MINING CLAIM MAINT FEE \$140 CASES: AMC426814/\$140.00, AMC426815/\$140.00, AMC426816/\$140.00		- n/a -	420.00
TOTAL:					\$582.00

PAYMENT INFORMATION			
1	AMOUNT:	582.00	POSTMARKED: 02/14/2014
	TYPE:	CHECK	RECEIVED: 02/14/2014
	CHECK NO:	5056	
	NAME:	DEPARTMENT OF LAND TRANSFER INFORMATION 942 CALLE AMANECER BLDG B548 SAN CLEMENTE CA 92673-6220 US	

REMARKS

This receipt was generated by the automated BLM Collections and Billing System and is a paper representation of a portion of the official electronic record contained therein.

NOTICE!!

These documents have been scanned!

Do not place un-scanned documents beneath this notice!

Do not remove this notice from this file!

GPO Jacket No. 560-102
Print Order 61540
Rise Business Services, LLC
Job=AZ15 6/6/2019



Box Number= AZ15125



Claim Begin-End: AMC426814-AMC426816

2 Correspondence



AZ15125-12

AMC356595-AMC427389



United States Department of the Interior

BUREAU OF LAND MANAGEMENT

Arizona State Office

One North Central Avenue, Suite 800

Phoenix, Arizona 85004-4427

www.blm.gov/az/

DEC 04 2017



In Reply Refer To:

3830 (9200) PB

AMC426814

CERTIFIED MAIL - RETURN RECEIPT REQUESTED No. 7017 0660 0000 3024 2383

DECISION

WILLIAM K PHILLIPS	:	This decision affects those claims shown
229 WINDY CUT ST	:	in the block below.
DOWELLTOWN, TN 37059-2284	:	

AMC426815
HEAVENS GATE MINE

MINING CLAIMS DECLARED FORFEITED

The mining claims listed above have been declared forfeit as of September 1, 2017, for failure to timely file the required maintenance fee payment or small miner's maintenance fee waiver (waiver).

Claimants are required to pay an annual non-refundable maintenance fee of \$155 per 20 acres or portion thereof, or submit a waiver, on or before September 1 of each year. These requirements were established by 30 U.S.C. 28f-l, as amended, and 43 CFR 3834 and 3835.

Our records do not show receipt of a maintenance fee payment or small miner waiver filed on or before the due date. Therefore, the claims listed above are forfeit.

Reclamation Requirements

This decision does not relieve you of the liability for reclamation of all areas disturbed by your activities on lands covered by the subject mining claim(s) and/or site(s). After you complete the reclamation, you must notify the authorized officer of the appropriate surface managing agency so that the authorized officer may conduct a final site inspection and determine whether you may be released from liability. If you fail to reclaim the land to the satisfaction of the authorized officer,

the surface management agency may cite you for noncompliance under its surface management regulations. For land administered by the Bureau of Land Management (BLM), if you fail to reclaim the land to the satisfaction of the authorized officer as required in 43 CFR Subpart 3809, BLM will issue an order of noncompliance under 43 CFR 3809.601(a). If you fail to comply with the non-compliance order, BLM may take further action under 43 CFR 3809.604. Failure to conduct reclamation is a prohibited act that may subject you to criminal penalties. See 43 CFR 3809.605(h) and 43 CFR 3809.700.

Appeal Procedures

This decision may be appealed to the Interior Board of Land Appeals, Office of the Secretary, in accordance with the regulations contained in 43 CFR, Part 4, and the enclosed Form 1842-1. If an appeal is taken, your notice of appeal must be filed in this office (at the above address) within 30 days from receipt of this decision. The appellant has the burden of showing that the decision appealed from is in error.

If you wish to file a petition pursuant to regulation 43 CFR 4.21 (58 FR 4939, January 19, 1993) for a stay of the effectiveness of this decision during the time that your appeal is being reviewed by the Board, the petition for a stay must accompany your notice of appeal. A petition for a stay is required to show sufficient justification based on the standards listed below. Copies of the notice of appeal and petition for a stay **must** also be submitted to each party named in this decision and to the Interior Board of Land Appeals and to the appropriate Office of the Solicitor (see 43 CFR 4.413) at the same time the original documents are filed with this office. If you request a stay, you have the burden of proof to demonstrate that a stay should be granted.

Standards for Obtaining a Stay

Except as otherwise provided by law or other pertinent regulation, a petition for a stay of a decision pending appeal shall show sufficient justification based on the following standards:

- (1) The relative harm to the parties if the stay is granted or denied,
- (2) The likelihood of the appellant's success on the merits,
- (3) The likelihood of immediate and irreparable harm if the stay is not granted, and
- (4) Whether the public interest favors granting the stay.

Please include your AMC serial number(s) on all correspondence. If additional information is required, please call Pauline Brown at 602-417-9360.

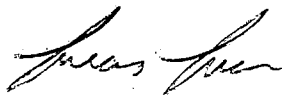

Lucas Lucero
Deputy State Director
Lands, Minerals, and Energy Division

Enclosure

SENDER: COMPLETE THIS SECTION

- Complete items 1, 2, and 3.
- Print your name and address on the reverse so that we can return the card to you.
- Attach this card to the back of the mailpiece, or on the front if space permits.

1. WILLIAM K PHILLIPS
229 WINDY CUT ST
DOWELLTOWN TN 37059-2284
AMC426814 PB 9200



9590 9402 1932 6123 9268 95

2. Article Number (Transfer from service label)

7017 0660 0000 3024 2383

COMPLETE THIS SECTION ON DELIVERY

A. Signature

X

William K Phillips

☐ Agent

☒ Addressee

B. Received by (Printed Name)

William K. Phillips

C. Date of Delivery

12-9-17

D. Is delivery address different from item 1?

☐ Yes

If YES, enter delivery address below:

☐ No

3. Service Type

- ☐ Adult Signature
- ☐ Adult Signature Restricted Delivery
- ☒ Certified Mail®
- ☐ Certified Mail Restricted Delivery
- ☐ Collect on Delivery
- ☐ Collect on Delivery Restricted Delivery
- ☐ Insured Mail

- ☐ Priority Mail Express®
- ☐ Registered Mail™
- ☐ Registered Mail Restricted Delivery
- ☐ Return Receipt for Merchandise
- ☐ Signature Confirmation™
- ☐ Signature Confirmation Restricted Delivery

1 Mail Restricted Delivery
500)

USPS TRACKING #



First-Class Mail
Postage & Fees Paid
USPS
Permit No. G-10

9590 9402 1982 6123 9288 95

United States
Postal Service

RECEIVED
BLM AZ STATE OFFICE

2017 DEC 12 P 2:19

PHOENIX, ARIZONA

Sender: Please print your name, address, and ZIP+4® in this box®

U.S. DEPARTMENT OF THE INTERIOR
BUREAU OF LAND MANAGEMENT
ARIZONA STATE OFFICE
ONE NORTH CENTRAL AVENUE, SUITE 800
PHOENIX, AZ 85004-4427





United States Department of the Interior

BUREAU OF LAND MANAGEMENT

Arizona State Office

One North Central Avenue, Suite 800

Phoenix, Arizona 85004-4427

www.blm.gov/az/



NOV 28 2014

In Reply Refer To:

3800 (9310) RM

AMC426814

CERTIFIED MAIL - RETURN RECEIPT REQUESTED No. 7014 0150 0000 5423 0664

DECISION

TRAVIS ORCUTT	:	This decision affects those claims shown
338 ROSEWOOD DR	:	in the block below.
FOUNTAIN, CO 80817-1732	:	

AMC426814
HARC ANGEL MINE

MINING CLAIMS DECLARED FORFEIT

The mining claims listed above have been declared forfeit as of September 1, 2014, for failure to timely file the required maintenance fee payment or small miner's maintenance fee waiver (waiver).

Claimants are required to pay an annual non-refundable maintenance fee of \$155 per 20 acres or portion thereof, or submit a waiver, on or before September 1 of each year. In accordance with 43 Code of Federal Regulations (CFR) 1822.14, because September 1, 2014, fell on a holiday, the payment was due the next business day, September 2, 2014. These requirements were established by 30 U.S.C. 28f-l, as amended, and 43 CFR 3834 and 3835.

Our records do not show receipt of a maintenance fee payment or small miner waiver filed on or before the due date. Therefore, the claims listed above are forfeit.

Reclamation Requirements

This decision does not relieve you of the liability for reclamation of all areas disturbed by your activities on lands covered by the subject mining claim(s) and/or site(s). After you complete the reclamation, you must notify the authorized officer of the appropriate surface managing agency so that the authorized officer may conduct a final site inspection and determine whether you may be released from liability. If you fail to reclaim the land to the satisfaction of the authorized officer, the surface management agency may cite you for noncompliance under its surface management

regulations. For land administered by the Bureau of Land Management (BLM), if you fail to reclaim the land to the satisfaction of the authorized officer as required in 43 CFR Subpart 3809, BLM will issue an order of noncompliance under 43 CFR 3809.601(a). If you fail to comply with the non-compliance order, BLM may take further action under 43 CFR 3809.604. Failure to conduct reclamation is a prohibited act that may subject you to criminal penalties. See 43 CFR 3809.605(h) and 43 CFR 3809.700.

Appeal Procedures

This decision may be appealed to the Interior Board of Land Appeals, Office of the Secretary, in accordance with the regulations contained in 43 CFR, Part 4, and the enclosed Form 1842-1. If an appeal is taken, your notice of appeal must be filed in this office (at the above address) within 30 days from receipt of this decision. The appellant has the burden of showing that the decision appealed from is in error.

If you wish to file a petition pursuant to regulation 43 CFR 4.21 (58 FR 4939, January 19, 1993) for a stay of the effectiveness of this decision during the time that your appeal is being reviewed by the Board, the petition for a stay must accompany your notice of appeal. A petition for a stay is required to show sufficient justification based on the standards listed below. Copies of the notice of appeal and petition for a stay **must** also be submitted to each party named in this decision and to the Interior Board of Land Appeals and to the appropriate Office of the Solicitor (see 43 CFR 4.413) at the same time the original documents are filed with this office. If you request a stay, you have the burden of proof to demonstrate that a stay should be granted.

Standards for Obtaining a Stay

Except as otherwise provided by law or other pertinent regulation, a petition for a stay of a decision pending appeal shall show sufficient justification based on the following standards:

- (1) The relative harm to the parties if the stay is granted or denied,
- (2) The likelihood of the appellant's success on the merits,
- (3) The likelihood of immediate and irreparable harm if the stay is not granted, and
- (4) Whether the public interest favors granting the stay.

Please include your AMC serial number(s) on all correspondence. If additional information is required, please call RéAnn Myers at 602-417-9413.

Sincerely,



Rebecca Heick
Acting Deputy State Director
Division of Lands and Minerals

Enclosure(s)



USPS Tracking™

[Customer Service >](#)

Have questions? We're here to help.

Tracking Number: 70140150000054230664**Updated Delivery Day: Saturday, December 6, 2014**

Product & Tracking Information

Postal Product:**Features:**

Certified Mail™

Available Actions

[Text Updates](#)[Email Updates](#)[Return Receipt After Mailing](#)**DATE & TIME****STATUS OF ITEM****LOCATION****December 6, 2014 , 12:07 pm****Delivered****FOUNTAIN, CO 80817**

Your item was delivered at 12:07 pm on December 6, 2014 in FOUNTAIN, CO 80817.

December 6, 2014 , 8:22 am

Arrived at Unit

FOUNTAIN, CO 80817

December 6, 2014 , 6:11 am

Departed USPS Facility

COLORADO
SPRINGS, CO 80910

December 6, 2014 , 12:21 am

Arrived at USPS Facility

COLORADO
SPRINGS, CO 80910

December 5, 2014 , 8:18 pm

Arrived at USPS Facility

DENVER, CO 80266

December 3, 2014 , 7:08 pm

Arrived at USPS Facility

PHOENIX, AZ 85026

Track Another Package

Tracking (or receipt) number[Track It](#)**HELPFUL LINKS**[Contact Us](#)[Site Index](#)[FAQs](#)**ON ABOUT.USPS.COM**[About USPS Home](#)[Newsroom](#)[USPS Service Updates](#)[Forms & Publications](#)[Government Services](#)[Careers](#)**OTHER USPS SITES**[Business Customer Gateway](#)[Postal Inspectors](#)[Inspector General](#)[Postal Explorer](#)[National Postal Museum](#)[Resources for Developers](#)**LEGAL INFORMATION**[Privacy Policy](#)[Terms of Use](#)[FOIA](#)[No FEAR Act EEO Data](#)

NOTICE!!

These documents have been scanned!

Do not place un-scanned documents beneath this notice!

Do not remove this notice from this file!

GPO Jacket No. 560-102
Print Order 61540
Rise Business Services, LLC
Job=AZ15 6/6/2019



Box Number= AZ15125



Claim Begin-End: AMC426814-AMC426816

3 Transfers



AZ15125-12

AMC356595-AMC427389



Amc 426814
DEPARTMENT OF LAND TRANSFER INFORMATION
PROTECTING AMERICA'S RESOURCES

STEVEN L. CYROS
SUPERVISORY FIELD AGENT

942 CALLE AMANECER
BLDG. B / MS 548
SAN CLEMENTE, CA 92673
TEL (949) 366-9484
FAX (949) 366-9945
SCYROS@DLTI.US.COM
WWW.LANDTRANSFER.US.COM

April 17, 2014

Bureau of Land Management
Arizona State Office
One Central Avenue
Suite 800
Phoenix, AZ 85004-4427

RE: Mining Claim Change of Ownership/Quitclaim Deed to be processed

To Whom It May Concern:

Enclosed, please find a Mining Claim Change of Ownership Request in the form of Legal Quitclaim Deed (Notarized) to be processed.

Also attached you will find my check for payment in the amount of \$10.00 for the processing of this Quitclaim Deed. This has already been recorded at the County Arizona Recorders Office as required.

You can either return this to me, and I will distribute it to the respective owner, or you can mail it to the individual whose name and address is indicated on the top of the document – whichever you prefer.

Should you need any additional information, please do not hesitate to call on me.

Warmest Regards,

Tina Bush
949.366.9484

RECEIVED
BLM AZ STATE OFFICE
2014 APR 21 P 3:23
PHOENIX, ARIZONA

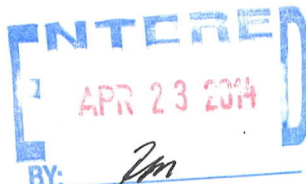

RECORDING REQUESTED BY:

(Mail recording to;)

William K Phillips

229 Windy Cut St.

Dowelltown, TN

37059

FOR RECORDER'S USE

UNPATENTED MINING CLAIM QUITCLAIM DEED

NOTICE IS HEREBY GIVEN that Department of Land Transfer Information, Inc., a Wyoming Corporation whose current mailing address is 942 Calle Amanecer, Suite B, San Clemente, CA 92673 (collectively, "GRANTOR"), in consideration of money received and other good and valuable consideration, do hereby remise, release and forever quitclaim to;

William K Phillips, whose mailing address is 229 Windy Cut St., Dowelltown, TN 37059 (collectively, "Grantee"), all rights, title and interest of Grantor, in and to the following mining claim; The **HEAVEN'S GATE MINE** lode mining claim, **AMC426815**.

BLM
Date
Stamp

PHOENIX, ARIZONA

2014 APR 21 P 3:23

RECEIVED
BLM AZ STATE OFFICE

The general course of this claim is North and South and it is situated in the Gila Salt River Meridian, La Paz County, Arizona. This claim is 600 feet wide and 1,500 feet tall. This claim runs from the location monument on which this location notice is posted approximately 1,200 feet in a Northerly direction to the North end line and approximately 300 feet in a Southerly direction to the South end line. This claim is marked by four (4) monuments, one at each corner of the claim. Additionally, there are two (2) end-line markers on each side of the center of the claim. All markers are 4" x 4" wooden posts that are buried 1.5' in the ground and protrude 4.5' above the ground embossed with the name of the claim and its location in relation to the claim. The location monument on which this notice is posted is situated within Section 17, Township 7N, Range 13W, Gila Salt River Meridian, La Paz County Arizona and this claim encompasses portions of the following quarter section (s), Township (s) and Range (s); NE 1/4 of SE 1/4 and SE 1/4 of NE 1/4 of Section 17, T7N, R13W, Gila Salt River Meridian, La Paz County Arizona. The locality of this claim with reference to some natural object or permanent monument and additional information (if any) concerning its locality are as follows: SE corner of this claim is the SE corner of NE 1/4 of SE 1/4 of Section 17, T7N, R13W.

IN WITNESS WHEREOF, this Mining Claim Quitclaim Deed is executed on April 14, 2014:

DEPARTMENT OF LAND TRANSFER INFORMATION, INC.



Steven L. Cyros, President

Authorized Officer for DEPARTMENT OF LAND TRANSFER INFORMATION, INC.

STATE OF CALIFORNIA
COUNTY OF ORANGE, SS:

On April 14, 2014 before me, James Pak, Notary Public, personally appeared Steven L. Cyros who proved to me on the basis of satisfactory evidence to be the person(s) whose names(s) is/are subscribed to the within instrument and acknowledged to me that he/she/they executed the same in his/her/their authorized capacity(ies), and that but his/her/their signatures(s) on the instrument the person(s), or the entity upon behalf of which the person(s) acted, executed the instrument.

WITNESS my hand and notarial seal.

Signature of officer

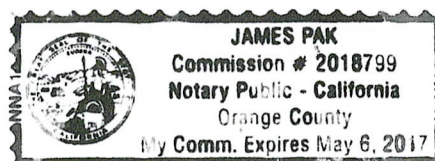



Department of Land Transfer

942 Calle Amanecer
Bldg. B / MS 548
San Clemente, CA 92673

RECEIVED
BLM AZ STATE OFFICE

2014 APR 21 PM 3:05

PHOENIX, ARIZONA

SANTA ANA CA 926

18 APR 2014 PM 3 L



Bureau of Land Management
Arizona State Office
One Central Avenue
Suite 800
Phoenix, AZ 85004-4427

85004442700



Department of Land Transfer

942 Calle Amanecer

Bldg. B / MS 548

San Clemente, CA 92673



United States Department of the Interior
Bureau of Land Management
LANDS/RECREATION & PLANNING
ONE N CENTRAL AVE
PHOENIX, AZ 85004 -2203
Phone: 602-417-9200

Receipt

No: 3015470

Transaction #: 3105459**Date of Transaction:** 04/22/2014

CUSTOMER:

DEPARTMENT OF LAND TRANSFER INFORMATION INC
942 CALLE AMANECER STE B
SAN CLEMENTE, CA 92673-6220 US

LINE #	QTY	DESCRIPTION	REMARKS	UNIT PRICE	TOTAL
1	1.00	LOCATABLE MINERALS / MINING CLAIMS- NOT NEW-UNADJUD, ONE AUTH NO. ONLY / MINING CLAIM MONEY RECEIVED CASES: AMC426815/\$10.00	QCD - 1	- n/a -	10.00
TOTAL:					\$10.00

PAYMENT INFORMATION				
1	AMOUNT:	10.00	POSTMARKED:	04/18/2014
	TYPE:	CHECK	RECEIVED:	04/21/2014
	CHECK NO:	5237		
	NAME:	DEPARTMENT OF LAND TRANSFER INFORMATION 942 CALLE AMANECER STE B SAN CLEMENTE CA 92673-6220 US		

REMARKS

This receipt was generated by the automated BLM Collections and Billing System and is a paper representation of a portion of the official electronic record contained therein.



DEPARTMENT OF LAND TRANSFER INFORMATION

PROTECTING AMERICA'S RESOURCES

STEVEN L. CYROS

SUPERVISORY FIELD AGENT

942 CALLE AMANECER

BLDG. B / MS 548

SAN CLEMENTE, CA 92673

TEL (949) 366-9484

FAX (949) 366-9945

SCYROS@DLTI.US.COM

WWW.LANDTRANSFER.US.COM

Amc 426814

April 11, 2014

Bureau of Land Management
Arizona State Office
One Central Avenue
Suite 800
Phoenix, AZ 85004-4427

RE: Mining Claim Change of Ownership/Quitclaim Deed to be processed

To Whom It May Concern:

Enclosed, please find a Mining Claim Change of Ownership Request in the form of Legal Quitclaim Deed (Notarized) to be processed.

Also attached you will find my check for payment in the amount of \$10.00 for the processing of this Quitclaim Deed. This has already been recorded at the Maricopa County Arizona Records Office as required.

You can either return this to me, and I will distribute it to the respective owner, or you can mail it to the individual whose name and address is indicated on the top of the document - whichever you prefer.

Should you need any additional information, please do not hesitate to call on me.

Warmest Regards,

Tina Bush
949.366.9484

RECEIVED
BLM AZ STATE OFFICE
2014 APR 14 P 3:12
PHOENIX, ARIZONA

RECORDING REQUESTED BY:

(Mail recording to;)

Robert Cornell

640 Orion Ct

Clifton, CO

81520

FOR RECORDER'S USE

UNPATENTED MINING CLAIM QUITCLAIM DEED

NOTICE IS HEREBY GIVEN that Department of Land Transfer Information, Inc., a Wyoming Corporation whose current mailing address is 942 Calle Amanecer, Suite B, San Clemente, CA 92673 (collectively, "GRANTOR"), in consideration of money received and other good and valuable consideration, do hereby remise, release and forever quitclaim to;

Robert Cornell, whose mailing address is 640 Orion Ct., 81520 (collectively, "Grantee"), all rights, title and interest of Grantor, in and to the following mining claim; The **KINGDOM** lode mining claim, **AMC426816**.

The general course of this claim is East and West and it is situated in the Gila Salt River Meridian, La Paz County, Arizona. This claim is 1,500 feet in length and 600 feet in width. This claim runs from the location monument on which this location notice is posted approximately 1,200 feet in an Easterly direction to the East end line and approximately 300 feet in a Southerly direction to the South end line. This claim is marked by four (4) monuments, one at each corner of the claim. Additionally, there are two (2) end-line markers on each side of the center of the claim. All markers are 4" x 4" wooden posts that are buried 1.5' in the ground and protrude 4.5' above the ground embossed with the name of the claim and its location in relation to the claim. The location monument on which this notice is posted is situated within Section 1, Township 7N, Range 13W, Gila Salt River Meridian, La Paz County Arizona and this claim encompasses portions of the following quarter section (s), Township (s) and Range (s); N 1/2 of SE 1/4 of NW 1/4 and SW 1/4 of NE 1/4 of Section 1, T7N, R13W, Gila Salt River Meridian, La Paz County Arizona. The locality of this claim with reference to some natural object or permanent monument and additional information (if any) concerning its locality are as follows: NW corner of this claim is the NW corner of SE 1/4 of NW 1/4 Section 1, T7N, R13W.

IN WITNESS WHEREOF, this Mining Claim Quitclaim Deed is executed on April 7, 2014:

DEPARTMENT OF LAND TRANSFER INFORMATION, INC.

Steven L. Cyros, President

Authorized Officer for DEPARTMENT OF LAND TRANSFER INFORMATION, INC.

STATE OF CALIFORNIA
COUNTY OF ORANGE, SS:

On April 7, 2014 before me, Brad Meindersma ^{Notary} ~~Public~~, personally appeared

Steve L. Cyros who proved to me on the basis of satisfactory evidence to be the person(s) whose names(s) ~~is~~ ^{are} subscribed to the within instrument and acknowledged to me that ~~he~~ ^{she} ~~they~~ executed the same in ~~his~~ ^{her} ~~their~~ authorized capacity(ies), and that but ~~his~~ ^{her} ~~their~~ signature(s) on the instrument the person(s), or the entity upon behalf of which the person(s) acted, executed the instrument.

WITNESS my hand and notarial seal.

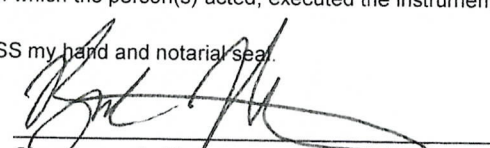
Signature of officer

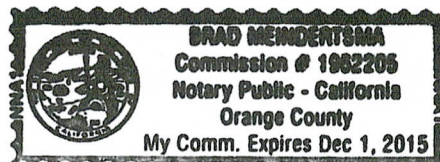
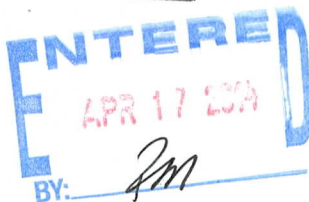

RECEIVED
BLM AZ STATE OFFICE
PHOENIX, ARIZONA
APR 14 P 3:12



Steven L. Cyros

942 Calle Amanecer
Bldg. B / MS 548
San Clemente, CA 92673

RECEIVED
BLM AZ STATE OFFICE
2014 APR 14 P 3:02
PHOENIX, ARIZONA

SANTA ANA CA 926

11 APR 2014 PM 2 L



Bureau of Land Management
Arizona State Office
One North Central Ave., Suite 800
Phoenix, AZ 85004-4427

85004442700



Steven L. Cyros

942 Calle Amanecer

Bldg. B / MS 548

San Clemente, CA 92673

United States Department of the Interior
Bureau of Land Management
LANDS/RECREATION & PLANNING
ONE N CENTRAL AVE
PHOENIX, AZ 85004 -2203
Phone: 602-417-9200

Receipt

No: 3010656

Transaction #: 3100453**Date of Transaction:** 04/15/2014

CUSTOMER:

DEPARTMENT OF LAND TRANSFER INFORMATION INC
942 CALLE AMANECER STE B
SAN CLEMENTE, CA 92673-6220 US

LINE #	QTY	DESCRIPTION	REMARKS	UNIT PRICE	TOTAL
1	1.00	LOCATABLE MINERALS / MINING CLAIMS- NOT NEW-UNADJUD, ONE AUTH NO. ONLY / MINING CLAIM MONEY RECEIVED CASES: AMC426816/\$10.00	QCD - 1	- n/a -	10.00
TOTAL:					\$10.00

PAYMENT INFORMATION				
1	AMOUNT:	10.00	POSTMARKED:	04/11/2014
	TYPE:	CHECK	RECEIVED:	04/14/2014
	CHECK NO:	5227		
	NAME:	DEPARTMENT OF LAND TRANSFER INFORMATION 942 CALLE AMANECER STE B SAN CLEMENTE CA 92673-6220 US		

REMARKS

This receipt was generated by the automated BLM Collections and Billing System and is a paper representation of a portion of the official electronic record contained therein.

AMC 426814

RECORDING REQUESTED BY:
(Mail recording to;)

Travis Orcutt
338 Rosewood Dr.
Fountain, CO
80817

FOR RECORDER'S USE

UNPATENTED MINING CLAIM QUITCLAIM DEED

NOTICE IS HEREBY GIVEN that Department of Land Transfer Information, Inc., a Wyoming Corporation whose current mailing address is 942 Calle Amanecer, Suite B, San Clemente, CA 92673 (collectively, "GRANTOR"), in consideration of money received and other good and valuable consideration, do hereby remise, release and forever quitclaim to;

Travis Orcutt, whose mailing address is 338 Rosewood Dr., Fountain, CO 80817 (collectively, "Grantee"), all rights, title and interest of Grantor, in and to the following mining claim; The **HARC ANGEL MINE** lode mining claim, **AMC426814**.

BLM Date Stamp	RECEIVED BLM AZ STATE OFFICE 2014 APR - 3 P 3:13 PHOENIX, ARIZONA
----------------------	--

The general course of this claim is East and West and it is situated in the Gila Salt River Meridian, La Paz County, Arizona.

This claim is 1,500 feet in length and 600 feet in width. This claim runs from the location monument on which this location notice is posted approximately 1,200 feet in an Easterly direction to the East end line and approximately 300 feet in a Southerly direction to the South end line.

This claim is marked by four (4) monuments, one at each corner of the claim. Additionally, there are two (2) end-line markers on each side of the center of the claim. All markers are 4" x 4" wooden posts that are buried 1.5' in the ground and protrude 4.5' above the ground embossed with the name of the claim and its location in relation to the claim.

The location monument on which this notice is posted is situated within Section 14, Township 7N, Range 13W, Gila Salt River Meridian, La Paz County Arizona and this claim encompasses portions of the following quarter section (s), Township (s) and Range (s); SE 1/4 of SW 1/4 and SW 1/4 of SE 1/4 of Section 14, T7N, R13W, Gila Salt River Meridian, La Paz County Arizona.

The locality of this claim with reference to some natural object or permanent monument and additional information (if any) concerning its locality are as follows: NW corner of this claim is 0 Feet South and 300 Feet East of the NW corner of SE 1/4 of SW 1/4 Section 14, T7N, R13W.

IN WITNESS WHEREOF, this Mining Claim Quitclaim Deed is executed on March 17, 2014:

DEPARTMENT OF LAND TRANSFER INFORMATION, INC.

Steven L. Cyros, President

Authorized Officer for DEPARTMENT OF LAND TRANSFER INFORMATION, INC.

STATE OF CALIFORNIA
COUNTY OF ORANGE, SS:

I, James Pak, a Notary Public in and for said County and State, hereby certify that Steven L. Cyros, personally appeared before me this day and acknowledged execution of the foregoing as his/her free and voluntary act and deed.

WITNESS my hand and notarial seal this 17th day of March, 2014.

Notary Public

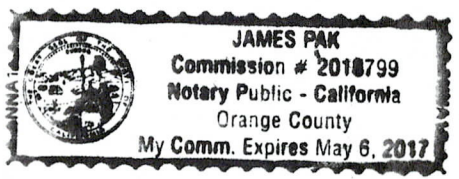

ENTERED
APR 08 2014
km



DEPARTMENT OF LAND TRANSFER INFORMATION

PROTECTING AMERICA'S RESOURCES

STEVEN L. CYROS
SUPERVISORY FIELD AGENT

942 CALLE AMANEKER
BLDG. B / MS 548
SAN CLEMENTE, CA 92673
TEL (949) 366-9484
FAX (949) 366-9945
SCYROS@DLTI.US.COM
WWW.LANDTRANSFER.US.COM

April 1, 2014

Bureau of Land Management
Arizona State Office
One Central Avenue
Suite 800
Phoenix, AZ 85004-4427

RE: Mining Claim Change of Ownership/Quitclaim Deed to be processed

To Whom It May Concern:

Enclosed, please find a Mining Claim Change of Ownership Request in the form of Legal Quitclaim Deed (Notarized) to be processed.

Also attached you will find my check for payment in the amount of \$10.00 for the processing of this Quitclaim Deed. This has already been recorded at the La Paz County Arizona Recorders Office as required.

You can either return this to me, and I will distribute it to the respective owners, or you can mail it to the individual whose name and address is indicated on the top of the document - whichever you prefer.

Should you need any additional information, please do not hesitate to call on me.

Warmest Regards,

Steven L. Cyrus

RECEIVED
BLM AZ STATE OFFICE
2014 APR -3 P 3:13
PHOENIX, ARIZONA



Department of Land Transfer

942 Calle Amanecer
Bldg. B / MS 548
San Clemente, CA 92673

RECEIVED
BLM AZ STATE OFFICE

2014 APR -3 P 3:09

PHOENIX, ARIZONA

Bureau of Land Management
Arizona State Office
One Central Avenue
Suite 800
Phoenix, AZ 85004-4427

SANTA ANA CA 925

01 APR 2014 PM 12 1



85004442700



Department of Land Transfer

942 Calle Amanecer

Bldg. B / MS 548

San Clemente, CA 92673



United States Department of the Interior
Bureau of Land Management
LANDS/RECREATION & PLANNING
ONE N CENTRAL AVE
PHOENIX, AZ 85004 -2203
Phone: 602-417-9200

Receipt

No: 3002764

Transaction #: 3092395**Date of Transaction:** 04/04/2014**CUSTOMER:**

DEPARTMENT OF LAND TRANSFER INFORMATION INC
942 CALLE AMANECER STE B
SAN CLEMENTE, CA 92673-6220 US

LINE #	QTY	DESCRIPTION	REMARKS	UNIT PRICE	TOTAL
1	1.00	LOCATABLE MINERALS / MINING CLAIMS- NOT NEW-UNADJUD, ONE AUTH NO. ONLY / MINING CLAIM MONEY RECEIVED CASES: AMC426814/\$10.00	QCD - 1	- n/a -	10.00
TOTAL:					\$10.00

PAYMENT INFORMATION

1	AMOUNT:	10.00	POSTMARKED:	04/01/2014
	TYPE:	CHECK	RECEIVED:	04/03/2014
	CHECK NO:	5182		
	NAME:	DEPARTMENT OF LAND TRANSFER INFORMATION 942 CALLE AMANECER STE B SAN CLEMENTE CA 92673-6220 US		

REMARKS

This receipt was generated by the automated BLM Collections and Billing System and is a paper representation of a portion of the official electronic record contained therein.

NOTICE!!

These documents have been scanned!

Do not place un-scanned documents beneath this notice!

Do not remove this notice from this file!

GPO Jacket No. 560-102
Print Order 61540
Rise Business Services, LLC
Job=AZ15 6/6/2019



Box Number= AZ15125



Claim Begin-End: AMC426814-AMC426816

4 Annual Filings



AZ15125-12

AMC356595-AMC427389

DEPARTMENT OF THE INTERIOR
BUREAU OF LAND MANAGEMENT
MINING CLAIMS

Run Date/Time: 9/11/2018

MC Maintenance Fees Paid Through the BLM Pay Portal
(by Date Paid)

Page 175 Of 723

CBS Receipt: 4243278

Printed For Lead File # AMC426814

Agency Tracking ID: 1535047505

Assessment Year: 2019

Paid On: 8/23/2018

Number of BLM Serial Nr: 1

Total Amount Paid: \$155.00

Claim Name	BLM Serial No	Lead File No	Amount Paid
KINGDOM MINE	AMC426816	AMC426814	\$155.00

United States Department of the Interior**Bureau of Land Management**

BUSINESS & SUPPORT SVCS DIV

ONE N CENTRAL AVE SUITE 800

PHOENIX, AZ 85004 -4427

Phone: 602-417-9200

Receipt

No:

4243278

Transaction #: 4358712**Date of Transaction:** 08/23/2018**CUSTOMER:**

ROBERT CORNELL
640 ORION CT
CLIFTON, CO 81520 US

LINE #	QTY	DESCRIPTION	REMARKS	UNIT PRICE	TOTAL
1	1.00	LOCATABLE MINERALS / MINING CLAIMS- NOT NEW-UNADJUD, ONE AUTH NO. ONLY / MINING CLAIM MONEY RECEIVED CASES: AMC426816/\$155.00		- n/a -	155.00
TOTAL:					\$155.00

PAYMENT INFORMATION

NOTE: Items will appear on credit card statement as "BLM O Mining Claim".

1	AMOUNT:	155.00	POSTMARKED:	N/A
	TYPE:	CREDIT CARD	RECEIVED:	08/23/2018
	NAME:	ROBERT CORNELL 640 ORION CT CLIFTON CO 81520 US		
	CARD NO:	XXXXXXXXXXXX9234	AUTH CODE:	012690
	NAME ON CARD:	ROBERT CORNELL		
	SIGNATURE:			

REMARKS

This receipt was generated by the automated BLM Collections and Billing System and is a paper representation of a portion of the official electronic record contained therein.

Run Date: 08/21/17

Run Time: 09:47 AM

**DEPARTMENT OF THE INTERIOR
BUREAU OF LAND MANAGEMENT
MINING CLAIMS**

MC Maintenance Fees Paid Through the BLM Pay Portal

CBS Receipt: 3936776

Printed For Lead File # AMC426814

Agency Tracking ID: 1502756925

Assessment Year: 2018

Number of BLM Serial Nr: 1

Paid On: 08/14/2017

Total Amount Paid: \$155.00

Claim Name	BLM Serial No	Lead File No	Amount Paid
KINGDOM MINE	AMC426816	AMC426814	\$155.00

United States Department of the Interior
Bureau of Land Management
BUSINESS & SUPPORT SVCS DIV
ONE N CENTRAL AVE SUITE 800
PHOENIX, AZ 85004 -4427
Phone: 602-417-9200

Receipt

No: 3936776

Transaction #: 4046400	
Date of Transaction: 08/14/2017	
CUSTOMER:	
	CORNELL ROBERT 640 ORION CT CLIFTON, CO 81520 US

LINE #	QTY	DESCRIPTION	REMARKS	UNIT PRICE	TOTAL
1	1.00	LOCATABLE MINERALS / MINING CLAIMS- NOT NEW-UNADJUD, ONE AUTH NO. ONLY / MINING CLAIM MONEY RECEIVED CASES: AMC426816/\$155.00		- n/a -	155.00
TOTAL:					\$155.00

PAYMENT INFORMATION				
NOTE: Items will appear on credit card statement as "BLM O Mining Claim".				
1	AMOUNT:	155.00	POSTMARKED:	N/A
	TYPE:	CREDIT CARD	RECEIVED:	08/14/2017
	NAME:	CORNELL ROBERT 640 ORION CT CLIFTON CO 81520 US		
	CARD NO:	XXXXXXXXXXXX0514	AUTH CODE:	417243
	NAME ON CARD:	CORNELL ROBERT		
	EXPIRES:	12/2018		
	SIGNATURE:			

REMARKS

This receipt was generated by the automated BLM Collections and Billing System and is a paper representation of a portion of the official electronic record contained therein.

Run Date: 08/25/16

Run Time: 05:50 AM

**DEPARTMENT OF THE INTERIOR
BUREAU OF LAND MANAGEMENT
MINING CLAIMS**

MC Maintenance Fees Paid Through the BLM Pay Portal

CBS Receipt: 3629743

Printed For Lead File # **AMC426814**

Agency Tracking ID: 1471093971

Assessment Year: 2017

Number of BLM Serial Nr: 1

Paid On: 08/13/2016

Total Amount Paid: \$155.00

Claim Name	BLM Serial No	Lead File No	Amount Paid
KINGDOM MINE	AMC426816	AMC426814	\$155.00

United States Department of the Interior
Bureau of Land Management
BUSINESS & SUPPORT SVCS DIV
ONE N CENTRAL AVE SUITE 800
PHOENIX, AZ 85004 -4427
Phone: (602) 417-9200

Receipt

No: 3629743

Transaction #: 3733521	
Date of Transaction: 08/13/2016	
CUSTOMER:	
	ROBERT CORNELL 640 ORION CT CLIFTON, CO 81520 US

LINE #	QTY	DESCRIPTION	REMARKS	UNIT PRICE	TOTAL
1	1.00	LOCATABLE MINERALS / MINING CLAIMS- NOT NEW-UNADJUD, ONE AUTH NO. ONLY / MINING CLAIM MONEY RECEIVED CASES: AMC426816/\$155.00		- n/a -	155.00
TOTAL:					\$155.00

PAYMENT INFORMATION				
NOTE: Items will appear on credit card statement as "BLM O Mining Claim".				
1	AMOUNT:	155.00	POSTMARKED:	N/A
	TYPE:	CREDIT CARD	RECEIVED:	08/13/2016
	NAME:	ROBERT CORNELL 640 ORION CT CLIFTON CO 81520 US		
	CARD NO:	XXXXXXXXXXXX0514	AUTH CODE:	903063
	NAME ON CARD:	ROBERT CORNELL		
	EXPIRES:	12/2018		
	SIGNATURE:			

REMARKS

This receipt was generated by the automated BLM Collections and Billing System and is a paper representation of a portion of the official electronic record contained therein.

AMC 426814

UNITED STATES
DEPARTMENT OF THE INTERIOR
BUREAU OF LAND MANAGEMENT

CREDIT CARD PAYMENT
For Mining Claim Maintenance Fee

☐ THIS IS A CHANGE OF ADDRESS

TELEPHONE SUBMISSION - ACCURACY OF THE BELOW INFORMATION IS THE RESPONSIBILITY OF THE CLAIMANT/OWNER

NAME William K. Phillips
ADDRESS 329 Windy Cut St.
CITY Morelandtown STATE UT ZIP 37059
PHONE # 615 - 318-5797

SEND RECEIPT TO ☒ Above address
☐ Other (Include Name and Mailing Address):

AMC NUMBER

426815

CLAIM/SITE NAME

DATE STAMP

RECEIVED
BLM AZ STATE OFFICE
2016 AUG 25 P 2:20
PHOENIX, ARIZONA

1 # of Claim/Site
x 155.00 Each
\$ 155 Total Charged WMC (INITIALS)

RECEIPT # 3641494

***** FOR OFFICIAL USE ONLY *****

DATE _____

INITIALS _____

VERIFIED _____

ENTERED
AUG 26 2016
BY: lm

**DEPARTMENT OF THE INTERIOR
BUREAU OF LAND MANAGEMENT
MINING CLAIMS
(MASS) Serial Register Page**

RunDate/Time:08/25/16 02:29 PM

Page: 1 of 1

01 05-10-1872;017STAT0091;30USC26,28,34

Case Type 384101: LODE CLAIM

Commodity:

Claim Name: HEAVENS GATE MINE

Case Disposition: ACTIVE

Required Maintenance Fee: \$155.00

Total Acres

20.660

Serial Number

AMC426815

Lead File Number

AMC426814

Name & Address

PHILLIPS WILLIAM K

229 WINDY CUT ST

DOWELLTOWN, TN 37059-2284

Int Rel

CLAIMANT

County/State

LA PAZ County, AZ

District

COLORADO RIVER DO

Mer Twp Rng Sec Subdivision

14 0070N 0130W 017 NE,SE

Act Date	Code	Action Text	Action Remarks	Receipt Number
12/10/2013	403	LOCATION DATE		
02/14/2014	395	RECORDATION NOTICE RECD	1	2969773
08/02/2015	782	MAINTENANCE FEE PAYMENT	2016;\$155	3356694
08/11/2014	782	MAINTENANCE FEE PAYMENT	2015;\$155	3098764
02/14/2014	484	LOCATION YEAR / MAINTENAN	2014;\$140	2969773
06/24/2014	669	LAND STATUS CHECKED		
04/21/2014	396	TRF OF INTEREST FILED	DEPARTMENT OF LAND TR	3015470
02/14/2014	501	ACCT ADV IN LEAD FILE	AMC426814-AMC426816;	

Line Nr Remarks

United States Department of the Interior
Bureau of Land Management
 DIV OF LANDS, MINRLS & ENERGY
 ONE N CENTRAL AVE
 PHOENIX, AZ 85004 -4427
 Phone: 602-417-9200

Receipt

No: 3641494

Transaction #: 3745438	
Date of Transaction: 08/25/2016	
CUSTOMER:	
WILLIAM K PHILLIPS 229 WINDY CUT ST DOWELLTOWN, TN 37059-2284 US	

LINE #	QTY	DESCRIPTION	REMARKS	UNIT PRICE	TOTAL
1	1.00	LOCATABLE MINERALS / MINING CLAIMS- NOT NEW-UNADJUD, ONE AUTH NO. ONLY / MINING CLAIM MONEY RECEIVED CASES: AMC426815/\$155.00	MAINT 2017/1	- n/a -	155.00
TOTAL:					\$155.00

PAYMENT INFORMATION			
NOTE: Items will appear on credit card statement as "Bureau of Land Mgmt CO".			
1	AMOUNT:	155.00	POSTMARKED: N/A
	TYPE:	CREDIT CARD	RECEIVED: 08/25/2016
	NAME:	PHILLIPS, WILLIAM K 229 WINDY CUT ST DOWELLTOWN TN 37059-2284 US	
	CARD NO:	XXXXXXXXXXXX3897	AUTH CODE: 030039
	NAME ON CARD:	WILLIAM K PHILIPS	
	EXPIRES:	03/2019	
	SIGNATURE:		

REMARKS

This receipt was generated by the automated BLM Collections and Billing System and is a paper representation of a portion of the official electronic record contained therein.

Run Date: 08/27/15

Run Time: 08:15 AM

**DEPARTMENT OF THE INTERIOR
BUREAU OF LAND MANAGEMENT
MINING CLAIMS**

MC Maintenance Fees Paid Through the BLM Pay Portal

CBS Receipt: 3375780

Printed For Lead File # AMC426814

Agency Tracking ID: 1440460269

Assessment Year: 2016

Number of BLM Serial Nr: 1

Paid On: 08/24/2015

Total Amount Paid: \$155.00

Claim Name	BLM Serial No	Lead File No	Amount Paid
KINGDOM MINE	AMC426816	AMC426814	\$155.00

United States Department of the Interior
Bureau of Land Management
BUSINESS & SUPPORT SVCS DIV
ONE N CENTRAL AVE SUITE 800
PHOENIX, AZ 85004 -4427
Phone: (602) 417-9200

Receipt

No: 3375780

Transaction #: 3474007	
Date of Transaction: 08/24/2015	
CUSTOMER:	
	ROBERT CORNELL 640 ORION CT CLIFTON, CO 81520 US

LINE #	QTY	DESCRIPTION	REMARKS	UNIT PRICE	TOTAL
1	1.00	LOCATABLE MINERALS / MINING CLAIMS- NOT NEW-UNADJUD, ONE AUTH NO. ONLY / MINING CLAIM MONEY RECEIVED CASES: AMC426816/\$155.00		- n/a -	155.00
TOTAL:					\$155.00

PAYMENT INFORMATION				
NOTE: Items will appear on credit card statement as "BLM O Mining Claim".				
1	AMOUNT:	155.00	POSTMARKED:	N/A
	TYPE:	CREDIT CARD	RECEIVED:	08/24/2015
	NAME:	ROBERT CORNELL 640 ORION CT CLIFTON CO 81520 US		
	CARD NO:	XXXXXXXXXXXX6850	AUTH CODE:	747038
	NAME ON CARD:	ROBERT CORNELL		
	EXPIRES:	02/2017		
	SIGNATURE:			

REMARKS

This receipt was generated by the automated BLM Collections and Billing System and is a paper representation of a portion of the official electronic record contained therein.

✓ Run Date: 08/13/14

27

Run Time: 03:20 PM

426814

**DEPARTMENT OF THE INTERIOR
BUREAU OF LAND MANAGEMENT
MINING CLAIMS**

MC Maintenance Fees Paid Through the BLM Pay Portal

CBS Receipt: 3098764

Agency Tracking ID: 1901318441

Assessment Year: 2015

Paid On : 08/11/2014

Number of BLM Serial Nr: 1

Total Amount Paid: \$155.00

Claim Name	BLM Serial No	Lead File No	Case Type	Amount Paid
HEAVENS GATE MINE	AMC426815	AMC426814	384101	\$155.00

United States Department of the Interior
Bureau of Land Management
 BUSINESS & SUPPORT SVCS DIV
 ONE N CENTRAL AVE SUITE 800
 PHOENIX, AZ 85004 -4427
 Phone: (602) 417-9200

Receipt

No: 3098764

Transaction #: 3190292**Date of Transaction:** 08/11/2014**CUSTOMER:**

WILLIAM K. PHILLIPS
 229 WINDY CUT ST
 DOWELLTOWN, TN 37059

LINE #	QTY	DESCRIPTION	REMARKS	UNIT PRICE	TOTAL
1	1.00	LOCATABLE MINERALS / MINING CLAIMS- NOT NEW-UNADJUD, ONE AUTH NO. ONLY / MINING CLAIM MONEY RECEIVED CASES: AMC426815/\$155.00		- n/a -	155.00
TOTAL:					\$155.00

PAYMENT INFORMATION

NOTE: Items will appear on credit card statement as "BLM Denver, Colorado".

1	AMOUNT:	155.00	POSTMARKED:	N/A
	TYPE:	CREDIT CARD	RECEIVED:	08/11/2014
	NAME:	WILLIAM K. PHILLIPS 229 WINDY CUT ST DOWELLTOWN TN 37059		
	CARD NO:	XXXXXXXXXXXX2821	AUTH CODE:	935282
	NAME ON CARD:	WILLIAM K. PHILLIPS		
	EXPIRES:	04/2015		
	SIGNATURE:			

REMARKS

This receipt was generated by the automated BLM Collections and Billing System and is a paper representation of a portion of the official electronic record contained therein.

Run Date: 08/13/14

10

Run Time: 03:20 PM

426814

**DEPARTMENT OF THE INTERIOR
BUREAU OF LAND MANAGEMENT
MINING CLAIMS**

MC Maintenance Fees Paid Through the BLM Pay Portal

CBS Receipt: 3096009

Agency Tracking ID: 1721991203

Assessment Year: 2015

Paid On : 08/07/2014

Number of BLM Serial Nr: 1

Total Amount Paid: \$155.00

Claim Name	BLM Serial No	Lead File No	Case Type	Amount Paid
KINGDOM MINE	AMC426816	AMC426814	384101	\$155.00

United States Department of the Interior
Bureau of Land Management
BUSINESS & SUPPORT SVCS DIV
ONE N CENTRAL AVE SUITE 800
PHOENIX, AZ 85004 -4427
Phone: (602) 417-9200

Receipt

No: 3096009

Transaction #: 3187490	
Date of Transaction: 08/07/2014	
CUSTOMER:	
	CORNELL ROBERT 640 ORION CT CLIFTON, CO 81520

LINE #	QTY	DESCRIPTION	REMARKS	UNIT PRICE	TOTAL
1	1.00	LOCATABLE MINERALS / MINING CLAIMS- NOT NEW-UNADJUD, ONE AUTH NO. ONLY / MINING CLAIM MONEY RECEIVED CASES: AMC426816/\$155.00		- n/a -	155.00
TOTAL:					\$155.00

PAYMENT INFORMATION				
NOTE: Items will appear on credit card statement as "BLM Denver, Colorado".				
1	AMOUNT:	155.00	POSTMARKED:	N/A
	TYPE:	CREDIT CARD	RECEIVED:	08/07/2014
	NAME:	CORNELL ROBERT 640 ORION CT CLIFTON CO 81520		
	CARD NO:	XXXXXXXXXXXX6850	AUTH CODE:	122216
	NAME ON CARD:	CORNELL ROBERT		
	EXPIRES:	02/2017		
	SIGNATURE:			

REMARKS

This receipt was generated by the automated BLM Collections and Billing System and is a paper representation of a portion of the official electronic record contained therein.

NOTICE!!

These documents have been scanned!

Do not place un-scanned documents beneath this notice!

Do not remove this notice from this file!

GPO Jacket No. 560-102
Print Order 61540
Rise Business Services, LLC
Job=AZ15 6/6/2019



Box Number= AZ15125



Claim Begin-End: AMC426814-AMC426816

5 Miscellaneous



AZ15125-12

AMC356595-AMC427389

**NO
DOCUMENTS
FOUND**

NO DOCUMENTS FOUND
NO DOCUMENTS FOUND

NOTICE!!

These documents have been scanned!

Do not place un-scanned documents beneath this notice!

Do not remove this notice from this file!

GPO Jacket No. 560-102
Print Order 61540
Rise Business Services, LLC
Job=AZ15 6/6/2019



Box Number= AZ15125



Claim Begin-End: AMC426814-AMC426816

6 Location Notices-Amendments and Supporting Documents



AZ15125-12

AMC356595-AMC427389

DEPARTMENT OF THE INTERIOR
BUREAU OF LAND MANAGEMENT

MINING CLAIMS

(LIVE) Serial Register Page

Run Date/Time: 02/21/2014 02:22 PM

Page 1 of 1

01 05-10-1872;017STAT0091;30USC26,28,34

Total Acres

Serial Number

Case Type 384101: LODE CLAIM

20.660

AMC426816

Claim Name: KINGDOM MINE

Lead File Number

Commodity :

AMC426814

Case Disposition: ACTIVE

Required Maintenance Fee: \$140.00

Name & Address

Int Rel

DEPARTMENT OF LAND
TRANSFER INFORMATION INC

942 CALLE AMANECER STE B

SAN CLEMENTE, CA 92673-6220

CLAIMANT

Mer Twp	Rng	Sec	Quadrant	District/Field Office	County	
14	0070N	0130W	001	NE,NW	LAKE HAVASU FO	LA PAZ

Act Date	Code	Action	Action Remarks	Receipt Number
12/10/2013	403	LOCATION DATE		
02/14/2014	395	RECORDATION NOTICE RECD	1	2969773
02/14/2014	484	LOCATION YEAR / MAINTENANC	2014;\$140	2969773
02/14/2014	501	ACCT ADV IN LEAD FILE	AMC426814-AMC426816;	

Line Nr Remarks

DEPARTMENT OF THE INTERIOR
BUREAU OF LAND MANAGEMENT
MINING CLAIMS

Run Date/Time: 02/21/2014 02:20 PM

(LIVE) Serial Register Page

Page 1 of 1

01 05-10-1872;017STAT0091;30USC26,28,34

Case Type 384101: LODE CLAIM

Claim Name: HEAVENS GATE MINE

Commodity :

Case Disposition: ACTIVE

Required Maintenance Fee: \$140.00

Total Acres

20.660

Serial Number

AMC426815

Lead File Number

AMC426814

Name & Address

Int Rel

DEPARTMENT OF LAND
TRANSFER INFORMATION INC

942 CALLE AMANECER STE B

SAN CLEMENTE, CA 92673-6220

CLAIMANT

Mer Twp	Rng	Sec	Quadrant	District/Field Office	County	
14	0070N	0130W	017	NE,SE	LAKE HAVASU FO	LA PAZ

Act Date	Code	Action	Action Remarks	Receipt Number
12/10/2013	403	LOCATION DATE		
02/14/2014	395	RECORDATION NOTICE RECD	1	2969773
02/14/2014	484	LOCATION YEAR / MAINTENANC	2014;\$140	2969773
02/14/2014	501	ACCT ADV IN LEAD FILE	AMC426814-AMC426816;	

Line Nr Remarks

DEPARTMENT OF THE INTERIOR
BUREAU OF LAND MANAGEMENT
MINING CLAIMS

Run Date/Time: 02/21/2014 02:18 PM

(LIVE) Serial Register Page

Page 1 of 1

01 05-10-1872;017STAT0091;30USC26,28,34

Case Type 384101: LODE CLAIM

Claim Name: HARC ANGEL MINE

Commodity :

Case Disposition: ACTIVE

Required Maintenance Fee: \$140.00

Total Acres

20.660

Serial Number

AMC426814

Lead File Number

AMC426814

Name & Address

Int Rel

DEPARTMENT OF LAND
TRANSFER INFORMATION INC

942 CALLE AMANECER STE B

SAN CLEMENTE, CA 92673-6220

CLAIMANT

Mer Twp	Rng	Sec	Quadrant	District/Field Office	County	
14	0070N	0130W	014	SW ,SE	LAKE HAVASU FO	LA PAZ

Act Date	Code	Action	Action Remarks	Receipt Number
12/10/2013	403	LOCATION DATE		
02/14/2014	395	RECORDATION NOTICE RECD	1	2969773
02/14/2014	484	LOCATION YEAR / MAINTENANC	2014;\$140	2969773
02/14/2014	501	ACCT ADV IN LEAD FILE	AMC426814-AMC426816;	

Line Nr Remarks

NO WARRANTY IS MADE BY BLM
FOR USE OF THE DATA FOR
PURPOSES NOT INTENDED BY BLM

MINING CLAIM STATUS REPORT

Data Entered: 2/21/2014 RM

MTP Checked By: RM

GEO Checked By: RM

LEAD SERIAL NUMBER: AMC 426814 thru AMC 426816

NUMBER OF CLAIMS & TYPE:

3 LODE
____ PLACER
____ ASSOCIATION PLACER
____ MILL SITE
____ TUNNEL SITE

CHARGES:

Location Fee @ \$34 = \$ 102
Processing Fee @ \$20 = \$ 60
Maintenance Fee @ \$140 = \$ 420
Add'l Maint Fee for Assoc Placer = \$ _____
SUBTOTAL \$ _____
Other Fees \$ _____
Other Fees \$ _____
TOTAL \$ 582.00

TOTAL ACREAGE: _____ Per Claim
(Placer Only)

NUMBER OF LOCATORS: _____

DOCUMENTS RECEIVED VIA : Over-the-Counter [] Mail ☒ **TIMELY FILED:** Yes ☒ No []

LEGAL DESCRIPTION: T 7N R 13W SEC 1, 14, 17
T _____ R _____ SEC _____
T _____ R _____ SEC _____
T _____ R _____ SEC _____
T _____ R _____ SEC _____

BLM [] FOREST SERVICE [] SUBJ TO PL 359: Yes [] No []
WILDERNESS AREA [] _____

SPLIT ESTATE: N/A [] SX [] PX [] OTHER [] _____
SRHA [] Was proper Notice filed if located on SHRA Land? Yes [] No []

RECONVEYED MINERALS ON BLM LAND REQUIRE OPENING ORDER FROM 1944 TO 1993:

Open to Entry On _____ N/A []

COMMENTS/STATUS: VOID [] PARTIALLY VOID [] PVT MINERALS [] WITHDRAWN LANDS []
OTHER [] _____

[] Claimant acknowledges that portions of the following claim(s) site(s) may be void or voidable.

Printed Name of Claimant _____ Signature of Claimant _____

*****FINAL ADJUDICATION*****

DATE 6/24/14 INITIALS AT

426814



DEPARTMENT OF LAND TRANSFER INFORMATION

PROTECTING AMERICA'S RESOURCES

STEVEN L. CYROS
SUPERVISORY FIELD AGENT

942 CALLE AMANECER
BLDG. B/MS 548
SAN CLEMENTE, CA 92673
TEL (949) 366-9484
FAX (949) 366-9945
SCYROS@DLTI.US.COM
WWW.LANDTRANSFER.US.COM

February 13, 2014

Bureau of Land Management
Arizona State Office
One Central Avenue
Suite 800
Phoenix, AZ 85004-4427

RE: Location Notices/Filings for Mining Claim and payment on the following new Mining Claims;

1. **HEAVEN'S GATE MINE** Mining Claim
2. **HARC ANGEL MINE** Mining Claim
3. **KINGDOM MINE** Mining Claim

To Whom It May Concern:

Enclosed, please find my check payable to Department of the Interior/BLM for payment in the amount of \$582.00 for the processing of the following three (3) location notices/new mining claims (3 claims X \$194.00/Each), as well as the signed location notices dated on December 10th of 2013 and a copy of the respective location maps.

Should you need any additional information, please do not hesitate to call on me.

Warmest Regards,

Steven L. Cyros, President

RECEIVED
BLM AZ STATE OFFICE
2014 FEB 14 P 2:14
PHOENIX, ARIZONA

APR 26 2014

RECORDING REQUESTED BY:

(Mail recording to;)

Department of Land

Transfer Information, Inc.

942 Calle Amanecer, Suite B

San Clemente, CA 92673

FOR RECORDER'S USE

LOCATION NOTICE FOR LODE MINING CLAIM

NOTICE IS HEREBY GIVEN that the **HARC ANGEL MINE** lode mining claim has been located by Department of Land Transfer Information, Inc., a Wyoming Corporation whose current mailing address is 942 Calle Amanecer, Suite B, San Clemente, CA 92673.

The general course of this claim is East and West and it is situated in the Gila Salt River Meridian, La Paz County, Arizona.

This claim is 1,500 feet in length and 600 feet in width. This claim runs from the location monument on which this location notice is posted approximately 1,200 feet in an Easterly direction to the East end line and approximately 300 feet in a Southerly direction to the South end line.

This claim is marked by four (4) monuments, one at each corner of the claim. Additionally, there are two (2) end-line markers on each side of the center of the claim. All markers are 4" x 4" wooden posts that are buried 1.5' in the ground and protrude 4.5' above the ground embossed with the name of the claim and its location in relation to the claim.

The location monument on which this notice is posted is situated within Section 14, Township 7N, Range 13W, Gila Salt River Meridian, La Paz County Arizona and this claim encompasses portions of the following quarter section (s), Township (s) and Range (s); SE 1/4 of SW 1/4 and SW 1/4 of SE 1/4 of Section 14, T7N, R13W, Gila Salt River Meridian, La Paz County Arizona.

The locality of this claim with reference to some natural object or permanent monument and additional information (if any) concerning its locality are as follows: NW corner of this claim is 0 Feet South and 300 Feet East of the NW corner of SE 1/4 of SW 1/4 Section 14, T7N, R13W.

DATED AND POSTED on the ground this 10th day of December, 2014²⁰¹³.

Locator of this lode mining claim is:

DEPARTMENT OF LAND TRANSFER INFORMATION, INC.



Steven L. Cyros, President

Authorized Officer for DEPARTMENT OF LAND TRANSFER INFORMATION, INC.

BLM
Date
Stamp

RECEIVED
BLM LAZ STATE OFFICE
2013 FEB 14 P 2:14
PHOENIX, ARIZONA

ALC0000010

MINING CLAIM MAP

- 1) Name of Claim; **HARC ANGEL MINE**
- 2) Type if Claim; **LODE**
- 3) Location Monument is located in Section 14, Township 7N, Range 13W, Gila Salt River Meridian, La Paz County, Arizona.
- 4) The types of corner and location monuments used are as follows: 4" X 4" Wooden Posts.

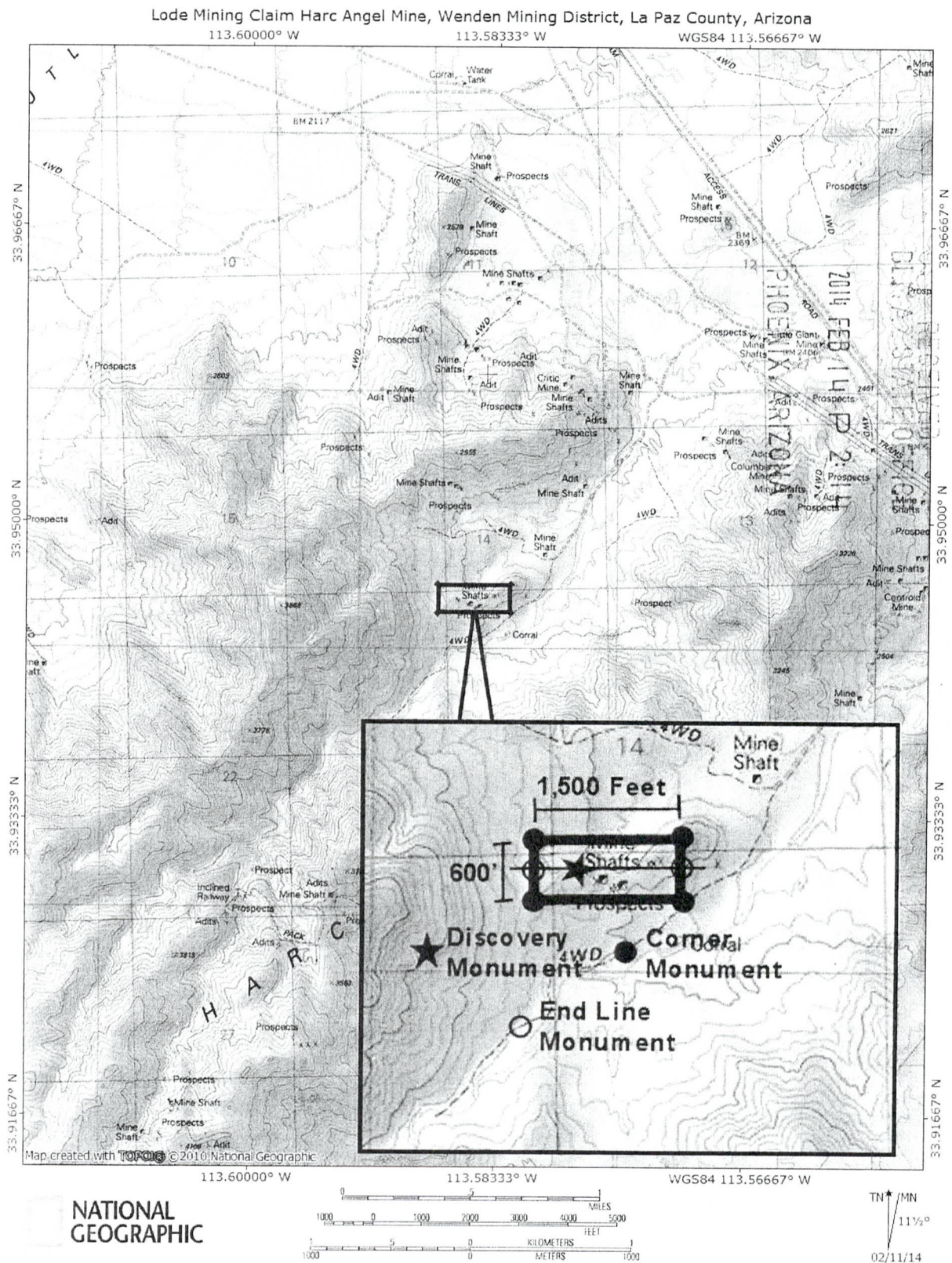

RECORDING REQUESTED BY:

(Mail recording to;)

Department of Land

Transfer Information, Inc.

942 Calle Amanecer, Suite B

San Clemente, CA 92673

FOR RECORDER'S USE

LOCATION NOTICE FOR LODE MINING CLAIM

NOTICE IS HEREBY GIVEN that the **HEAVEN'S GATE MINE** lode mining claim has been located by Department of Land Transfer Information, Inc., a Wyoming Corporation whose current mailing address is 942 Calle Amanecer, Suite B, San Clemente, CA 92673.

The general course of this claim is North and South and it is situated in the Gila Salt River Meridian, La Paz County, Arizona.

This claim is 600 feet wide and 1,500 feet tall. This claim runs from the location monument on which this location notice is posted approximately 1,200 feet in a Northerly direction to the North end line and approximately 300 feet in a Southerly direction to the South end line.

This claim is marked by four (4) monuments, one at each corner of the claim. Additionally, there are two (2) end-line markers on each side of the center of the claim. All markers are 4" x 4" wooden posts that are buried 1.5' in the ground and protrude 4.5' above the ground embossed with the name of the claim and its location in relation to the claim.

The location monument on which this notice is posted is situated within Section 17, Township 7N, Range 13W, Gila Salt River Meridian, La Paz County Arizona and this claim encompasses portions of the following quarter section (s), Township (s) and Range (s); NE 1/4 of SE 1/4 and SE 1/4 of NE 1/4 of Section 17, T7N, R13W, Gila Salt River Meridian, La Paz County Arizona.

The locality of this claim with reference to some natural object or permanent monument and additional information (if any) concerning its locality are as follows: SE corner of this claim is the SE corner of NE 1/4 of SE 1/4 of Section 17, T7N, R13W.

DATED AND POSTED on the ground this 10th day of December, ²⁰¹³2014.

Locator of this lode mining claim is:

DEPARTMENT OF LAND TRANSFER INFORMATION, INC.



Steven L. Cyros, President

Authorized Officer for DEPARTMENT OF LAND TRANSFER INFORMATION, INC.

RECEIVED BLM STATE OFFICE 2014 FEB 14 P 2:14 PHOENIX, ARIZONA	BLM Date Stamp
--	----------------------

RECORDED

MINING CLAIM MAP

- 1) Name of Claim; **HEAVEN'S GATE MINE**
- 2) Type if Claim; **LODE**
- 3) Location Monument is located in Section 17, Township 7N, Range 13W, Gila Salt River Meridian, La Paz County, Arizona.
- 4) The types of corner and location monuments used are as follows: 4" X 4" Wooden Posts.

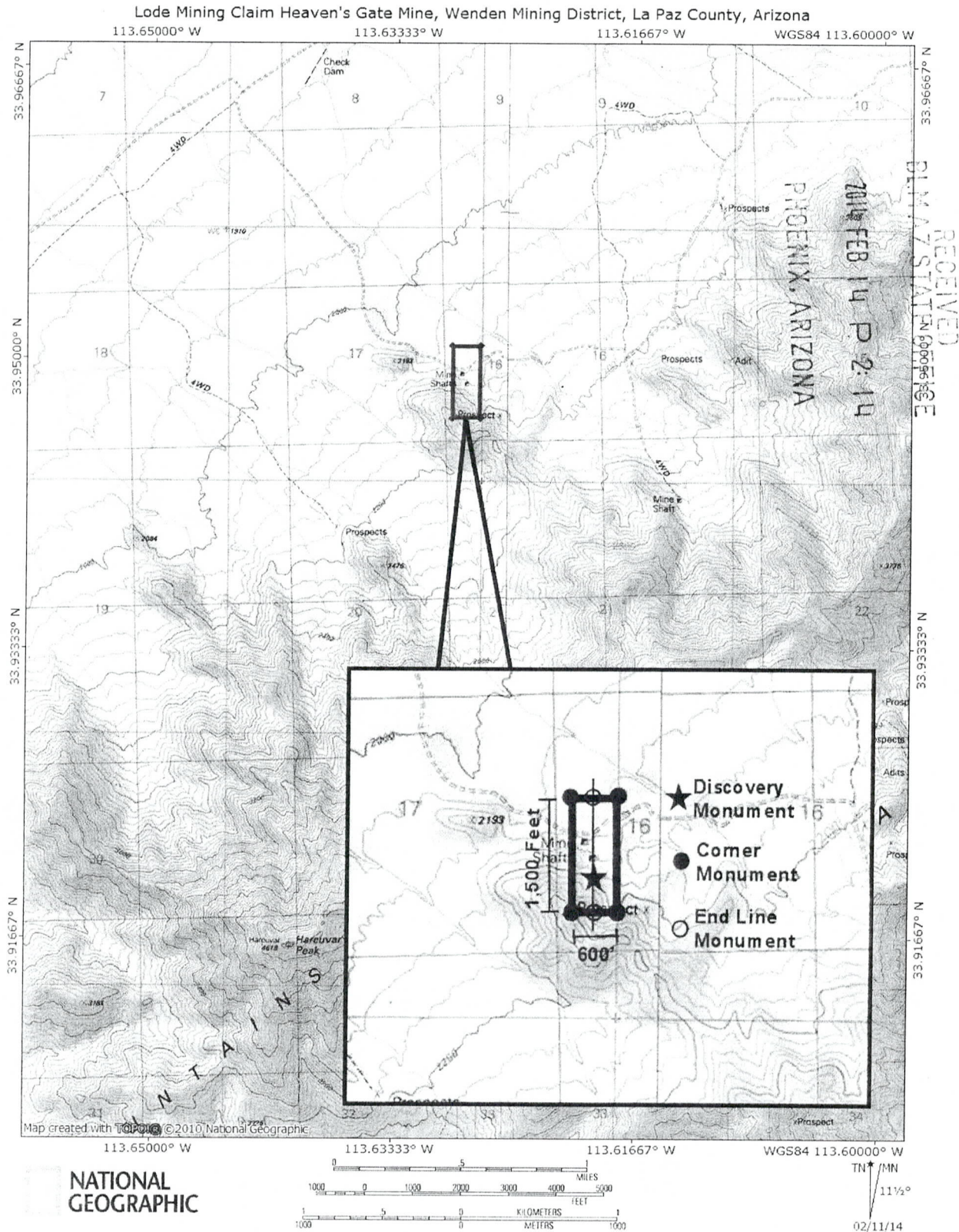

RECORDING REQUESTED BY:

(Mail recording to;)

Department of Land

Transfer Information, Inc.

942 Calle Amanecer, Suite B

San Clemente, CA 92673

FOR RECORDER'S USE

LOCATION NOTICE FOR LODE MINING CLAIM

NOTICE IS HEREBY GIVEN that the **KINGDOM MINE** lode mining claim has been located by Department of Land Transfer Information, Inc., a Wyoming Corporation whose current mailing address is 942 Calle Amanecer, Suite B, San Clemente, CA 92673.

The general course of this claim is East and West and it is situated in the Gila Salt River Meridian, La Paz County, Arizona.

This claim is 1,500 feet in length and 600 feet in width. This claim runs from the location monument on which this location notice is posted approximately 1,200 feet in an Easterly direction to the East end line and approximately 300 feet in a Southerly direction to the South end line.

This claim is marked by four (4) monuments, one at each corner of the claim. Additionally, there are two (2) end-line markers on each side of the center of the claim. All markers are 4" x 4" wooden posts that are buried 1.5' in the ground and protrude 4.5' above the ground embossed with the name of the claim and its location in relation to the claim.

The location monument on which this notice is posted is situated within Section 1, Township 7N, Range 13W, Gila Salt River Meridian, La Paz County Arizona and this claim encompasses portions of the following quarter section (s), Township (s) and Range (s); N 1/2 of SE 1/4 of NW 1/4 and SW 1/4 of NE 1/4 of Section 1, T7N, R13W, Gila Salt River Meridian, La Paz County Arizona.

The locality of this claim with reference to some natural object or permanent monument and additional information (if any) concerning its locality are as follows: NW corner of this claim is the NW corner of SE 1/4 of NW 1/4 Section 1, T7N, R13W.

DATED AND POSTED on the ground this 10th day of December, ²⁰¹³~~2014~~.

Locator of this lode mining claim is:

DEPARTMENT OF LAND TRANSFER INFORMATION, INC.

Steven L. Cyros, President

Authorized Officer for DEPARTMENT OF LAND TRANSFER INFORMATION, INC.

BLM

Date

Stamp

RECEIVED
CLIMATE OFFICE
2014 FEB 14 P 2:14
PHOENIX, ARIZONA

MINING CLAIM MAP

- 1) Name of Claim; **KINGDOM MINE**
- 2) Type if Claim; **LODE**
- 3) Location Monument is located in Section 1, Township 7N, Range 13W, Gila Salt River Meridian, La Paz County, Arizona.
- 4) The types of corner and location monuments used are as follows: 4" X 4" Wooden Posts.

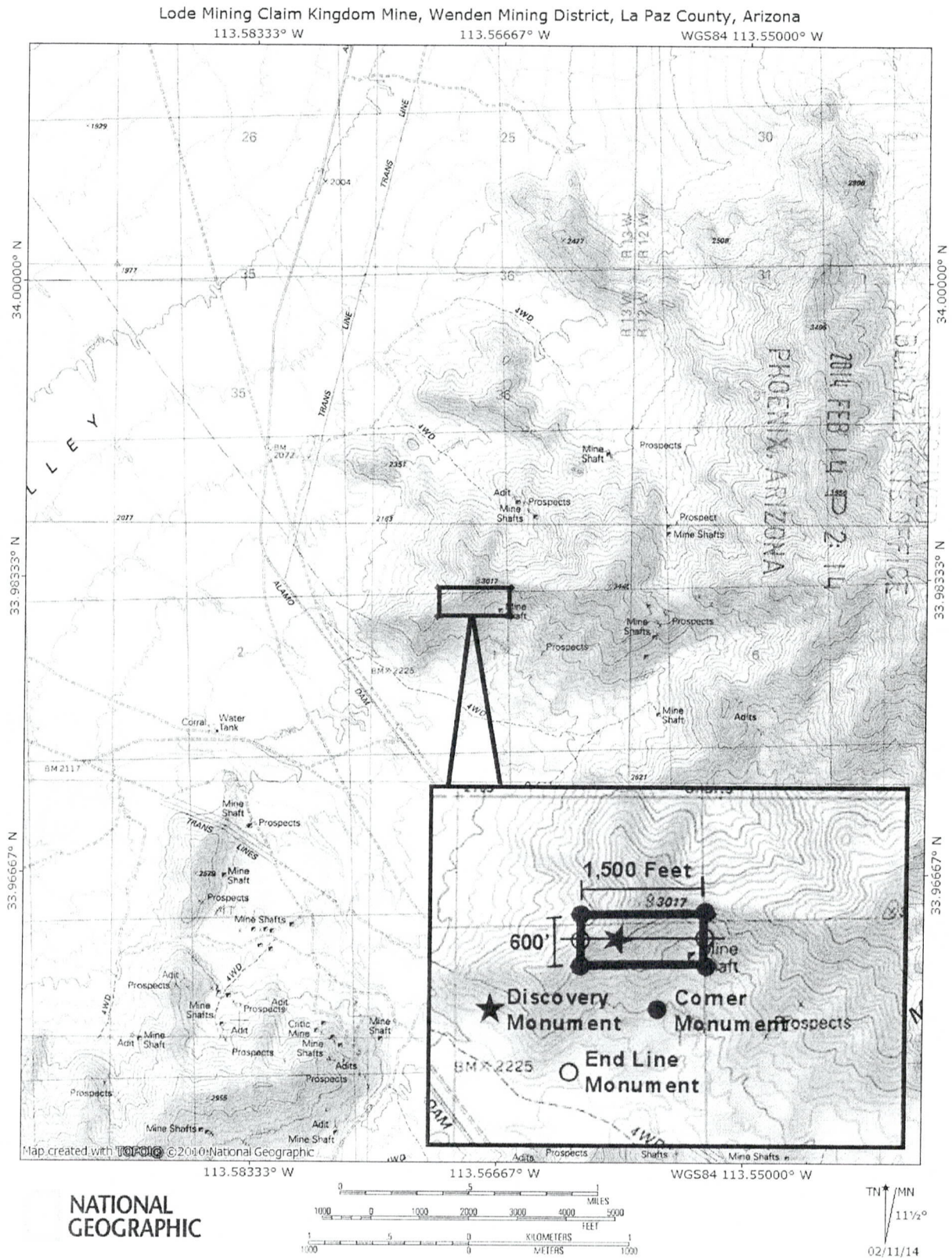

Input Parameters for Geographic Report with Land

System Id = CR

Admin State = AZ

Geo State =

Casetype Begins With

Case Disp Txt = AUTHORIZED, CANCELLED, EXPIRED, PENDING, REJECTED, RELINQUISHED, VOID, WITHDRAWN

Mer Twp Rng = 14 0070N 0130W

Section = 001, 014, 017, 999

Mtrs =

Commodity =

Commodity Txt =

Pending Org =

Pend Org Decode =

Total Rows Returned: 3

RUN TIME: 02:24 PM

UNITED STATES DEPARTMENT OF INTERIOR
BUREAU OF LAND MANAGEMENT
GEOGRAPHIC REPORT WITH LAND
Sorted by Serial Number

RUN DATE: 02/21/2014
Page 1 of 1

Serial Number: AZA 027844
Total Case Acres: 85.660

<u>Casetype</u>	<u>Case Disp</u>	14	0070N	0130W	<u>Sect</u>	<u>Sur Typ</u>	<u>Sur Num</u>	<u>Suff</u>	<u>Subdivision</u>	<u>Act Pend</u>
286203	AUTHORIZED				001	ALIQ			W2SW;	

Serial Number: AZA 033197
Total Case Acres: 48.623

<u>Casetype</u>	<u>Case Disp</u>	14	0070N	0130W	<u>Sect</u>	<u>Sur Typ</u>	<u>Sur Num</u>	<u>Suff</u>	<u>Subdivision</u>	<u>Act Pend</u>
285003	AUTHORIZED				001	ALIQ			W2SW;	

Serial Number: AZPHX 0086056
Total Case Acres: 542.590

<u>Casetype</u>	<u>Case Disp</u>	14	0070N	0130W	<u>Sect</u>	<u>Sur Typ</u>	<u>Sur Num</u>	<u>Suff</u>	<u>Subdivision</u>	<u>Act Pend</u>
288100	AUTHORIZED				001	ALIQ			W2SW;	

Extremely Urgent

This envelope is for use with the following services:

UPS Next Day Air®
UPS Worldwide Express®
UPS 2nd Day Air®

Visit **ups.com®** or call **1-800-PICK-UPS®** (1-800-742-5877) to schedule a pickup or find a drop off location near you.

Domestic Shipments

- To qualify for the Letter rate, UPS Express Envelopes may only contain correspondence, urgent documents, and/or electronic media, and must weigh 8 oz. or less. UPS Express Envelopes containing items other than those listed or weighing more than 8 oz. will be billed by weight.

International Shipments

- The UPS Express Envelope may be used only for documents of no commercial value. Certain countries consider electronic media as documents. Visit ups.com/importexport to verify if your shipment is classified as a document.
- To qualify for the Letter rate, the UPS Express Envelope must weigh 8 oz. or less. UPS Express Envelopes weighing more than 8 oz. will be billed by weight.

Note: Express Envelopes are not recommended for shipments of electronic media containing sensitive personal information or breakable items. Do not send cash or cash equivalent.

Apply shipping documents on this side.

Do not use this envelope for:

UPS Ground
UPS Standard
UPS 3 Day Select®

STEVEN CYROS
(949) 366-9484
PTF TECHNOLOGIES, INC.
942 CALLE AMANECER, SUITE B
SAN CLEMENTE CA 92673-6220

LTR 1 OF 1

SHIP TO:

ARIZONA STATE OFFICE
(602) 417-9200
BUREAU OF LAND MANAGEMENT
SUITE 800
ONE CENTRAL AVENUE
PHOENIX AZ 85004-4427



AZ 850 9-10



UPS NEXT DAY AIR SAVER 1P
TRACKING #: 1Z 614 Y2R 13 6805 3808

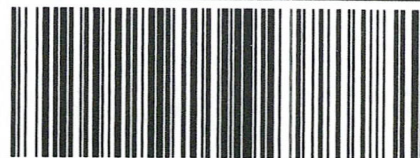

BILLING: P/P

PHOENIX, ARIZONA
2014 FEB 14 P 2:15
RECEIVED
BLM AZ STATE OFFICE

International Shipping Notice — Carriage hereunder may be subject to the rules relating to liability and other terms and/or conditions established by the Convention for the Unification of Certain Rules of Contract for the International Carriage of Goods by Road (the "CMR Convention"). These commodities, technology or software were exported from the U.S. in accordance with the Export Administration

WS 17.0.21

LP2442 48.0A 01/2014



SEE NOTICE ON REVERSE regarding UPS Terms, and notice of limitation of liability. Where allowed by law, shippers authorize UPS to act as forwarding agent for export control and customs purposes. If exported from the U.S., shipper certifies that the commodities, technology or software were exported from the U.S. in accordance with the Export Administration Regulations. Shipment contrary to law is prohibited.

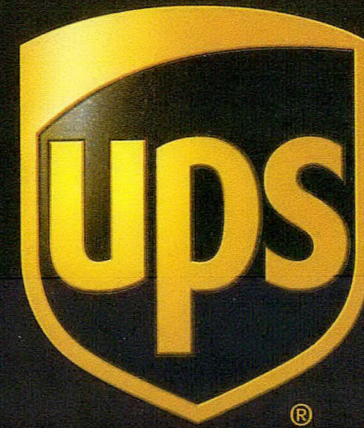

Synchronizing the world of commerceSM

Express Envelope